

C

B

A

3

2

1

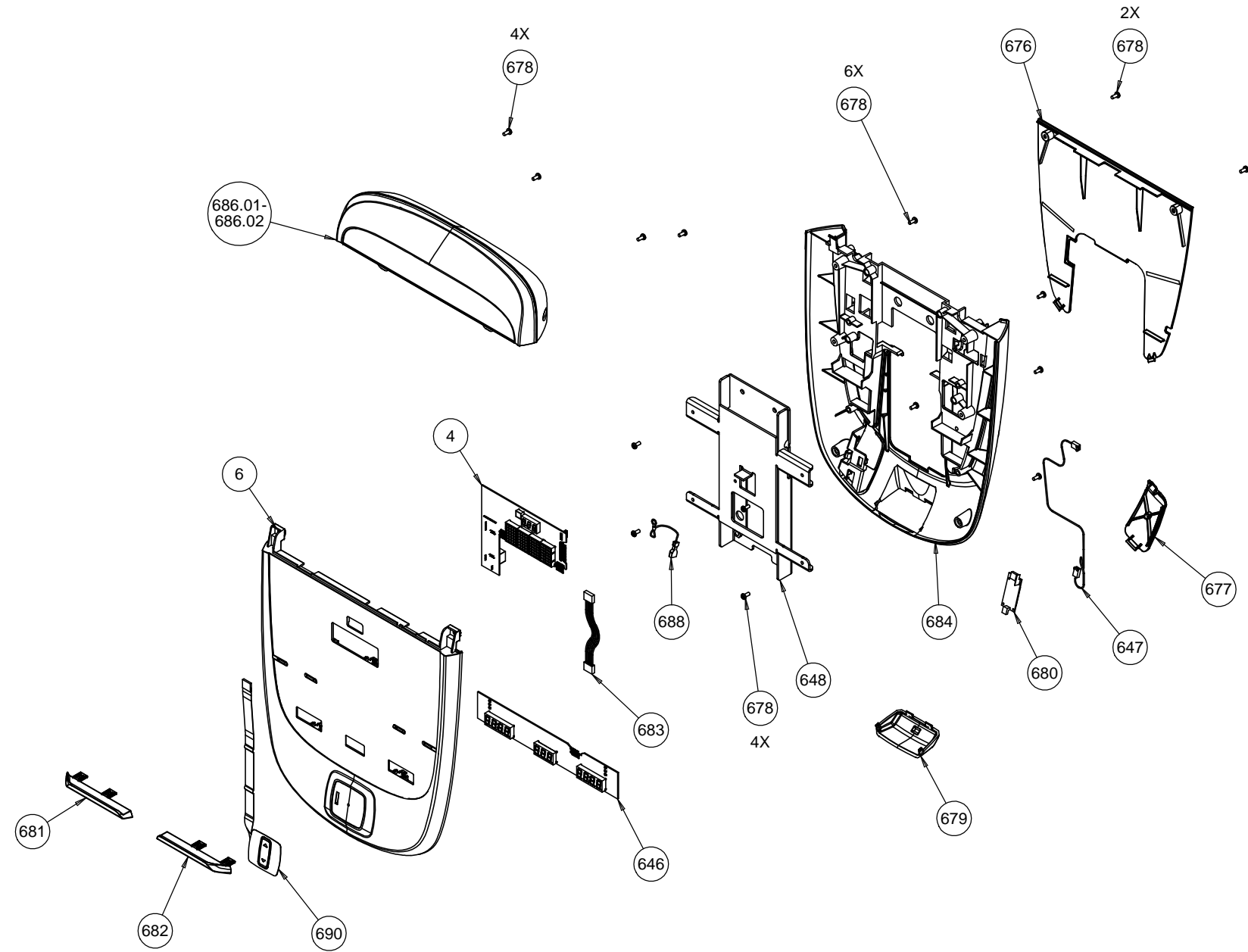

PRODUCT:  
**P10 CONSOLE**

**PRECOR**

DRWN BY	8/4/14	KAW	SIZE	PAGE	OF	DWG. NO.	SUBREV
CS	05.06.13	BG	A	1	1	302725-101	B

Bubble#	OEM#	Description
4.01	PPP000000302189102	ASSY, P10, UPPER PCA & SW, EFX 815,
6	PPP000000058044101	DISPLAY HOUSING, P10, EFX, MOVABLE
646	PPP000000302206103	ASSY, P10, METRICS PCA & SW, QUAD,
647	PPP000000040015020	ASSY,CBL,3C,.1 CTR,W/RAMP,1-1,SN,20
648	PPP000000300285102	WELDMENT,DISPLAY,PT - P10/P30/P20
676	PPP000000300278103	PLASTIC, SERVICE COVER, DISPLAY, P2
677	PPP000000300283101	PLASTIC, HR DOOR, P40/P30/P20, SILV
678	PPP000000MGCN016038	SCREW,MCH,8-32X3/8,PANHD,PHIL,
679	PPP000000303733101	ASSY,USB-JACK, TOP BLANK CAP
680	PPP000000300812131	BOARD, CHR & WIRELESS, SALUTRON, OR
681	PPP000000303176101	SUPPORT,BOOK,LEFT,P30/P10
682	PPP000000303176102	SUPPORT,BOOK,RIGHT,P30/P10
683	PPP000000035754006	ASSY,CABLE,6C, .1 CTR,1-1,TIN, 6 in.
684	PPP000000300277103	PLASTIC, REAR, DISPLAY ,P40/P30/P20
686.01	PPP000000300205104	PRODUCT,BLANK CAP,P10/P20/P30/P40
688	PPP000000301415008	CBL,1C,20AWG,#8 RING/250X032 QD REC
750	PPP000000304178102	ASSY,PLASTIC,OPTION CAP,REAR (W/LOO
751	PPP000000304177101	ASSY,PLASTIC,OPTION CAP,FRONT,BLANK